

CALL TABLE		
Course	Bearing	Distance
1	S 30° 36' 08" E	103.35'
2	S 54° 40' 00" E	122.98'
3	S 49° 08' 50" E	490.02'

**AIS ROUND COORDINATES:**  
 N 660570.43' E 606083.79'  
 GRID COORDINATES  
 N 660570.42' E 606084.109'  
 SF: 0.999892782  
 NOTE: ALL DISTANCES SHOWN ARE GROUND.

**NOTES:**

- THIS SURVEY WAS PERFORMED WITH A TOPCON GTS-303 TOTAL STATION, A 100' TAPE, AND PROMARK 500 GNSS SURVEYING SYSTEM.
- ACCURACY OF FIELD WORK ACQUIRED TO PREPARE THIS PLAT
  - TOPCON GTS-303 TOTAL STATION ANGLE ERROR OF 0.000104" PER POINT AND 0.000104" PER FOOT IN 15.14 (UNADJUSTED) AND ONE FOOT IN 17.058 (ADJUSTED).
  - PROMARK GNSS SURVEYING SYSTEM (REAL TIME NETWORK) HORIZONTAL POSITIONAL ERROR TOLERANCE AT 95% CONFIDENCE LEVEL IS 0.08".
  - THIS PLAT HAS A CLOSURE PRECISION THAT EXCEEDS ONE FOOT IN 100,000 FEET.

**LEGEND**

1. IPF - IRON PIPE FOUND
2. IPS - IRON PIPE SET
3. AIF - ANGLE IRON FOUND
4. AIS - ANGLE IRON SET
5. CTF - CRIMPED TOP PIPE FOUND
6. CMT - CONC. MONUMENT FOUND
7. CMC - CONC. MONUMENT SET
8. RBF - REBAR FOUND
9. RBS - REBAR SET
10. SIF - SQUARE IRON FOUND
11. OTF - OPEN TOP PIPE FOUND
12. RRI - RAILROAD IRON
13. CSS - COTTON SPIKE SET
14. CSF - COTTON SPIKE FOUND
15. \*\* - FENCE

File No. \_\_\_\_\_  
 Hour Filed \_\_\_\_\_  
 Date Filed \_\_\_\_\_  
 Deputy Clerk Superior Court  
 Appling County, Georgia

REFERENCE:  
 PB 7 PG 110  
 DB 152 PG 213

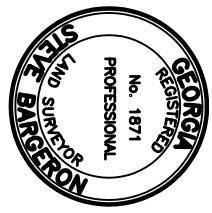

**PROPOSED DIVISION OF A PLAT OF SURVEY FOR RAYONIER FOREST RESOURCES, L.P.**

BRING TRACT 2010-2-8 AND LOCATED IN THE 338th. & 339th. LAND LOTS APPLING COUNTY, GEORGIA  
 SCALE: 1" = 300'  
 Prepared by  
**STEVE BARBERON & ASSOCIATES**  
 VAINESBORO, GEORGIA (706)364-8888  
 FEBRUARY 4, 2010  
 090359  
 090359R.dwg  
 MAP 48 PAR 25

